

1. With the Bantam Tool in the Pistol Grip Position, place the band in the tool with sufficient band in the winding mandrel.



2. With ratcheting action, tension the band until clamp is tight. If necessary, band may be repositioned by releasing tension with levers.



3. Roll tool over as far as tool will go, and push forward cutter handle. Remove tool and tap down ears of clip to complete clamp. Remove excess material from winding mandrel.

Straight or Angle Position:

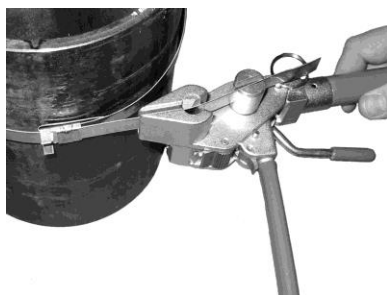

1. With the Bantam Tool in the Straight Position, place the band in the tool with sufficient band in the winding mandrel.



2. With ratcheting action, tension the band until clamp is tight.

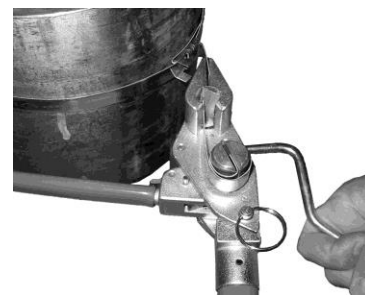

3. Roll tool over as far as tool will go, and push forward cutter handle. Remove tool and tap down ears of clip to complete clamp.

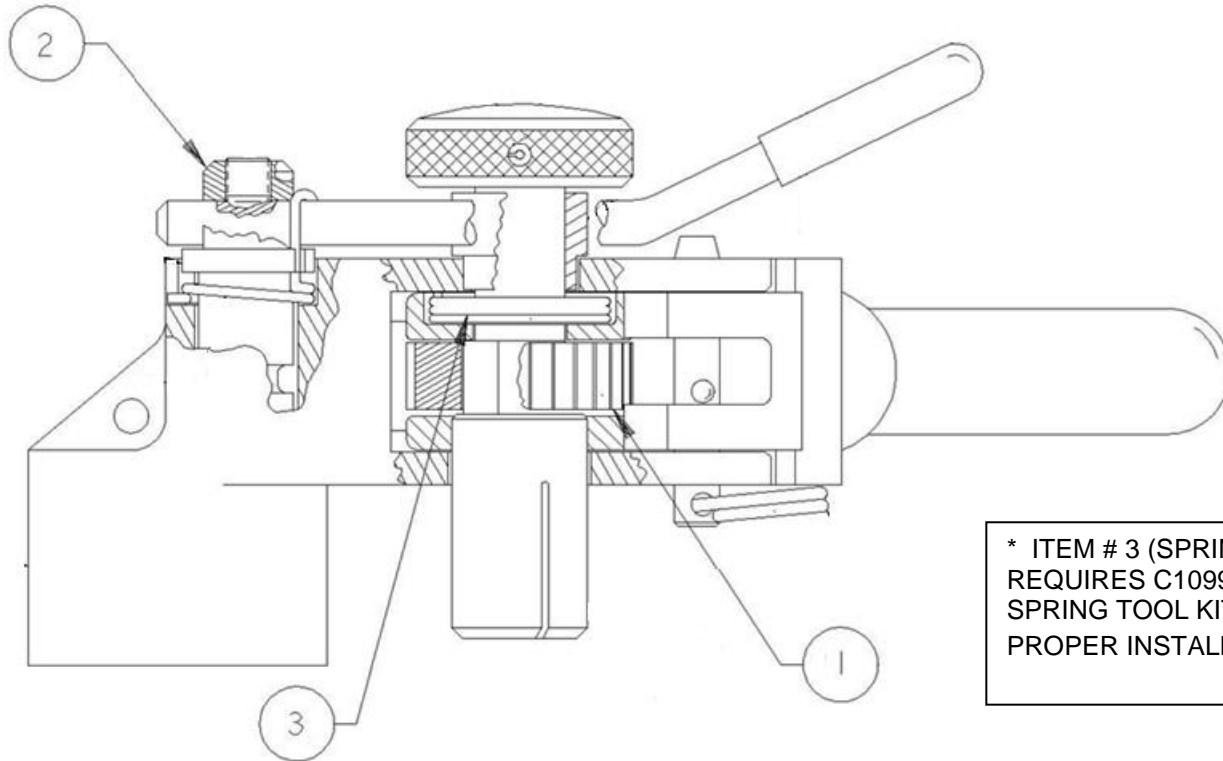

* ITEM # 3 (SPRING)
REQUIRES C10999 -(RATCHET
SPRING TOOL KIT) FOR
PROPER INSTALLATION.

C075 BAND-IT BANTAM STRAPPING TOOL, REPAIR PARTS LIST			
ITEM	PART NUMBER	QTY.	DESCRIPTION
1	C07887	1	WHEEL, RATCHET
2	C08787	1	BLADE, CUTTER, FINISHED
3	C09087*	1	SPRING, RATCHET

* NOTE: ITEM 3 (SPRING) REQUIRES RATCHET SPRING TOOL FOR PROPER INSTALLATION. ORDER PART NUMBER C10999 FOR RATCHET SPRING TOOL AND C09099 FOR SPRING KIT (INCLUDES THREE SPRINGS).

Refer to website for warranty information: <https://www.band-it-idex.com/terms-conditions/>