

### HEAVY DUTY BOLT CLAMP (CASTING)

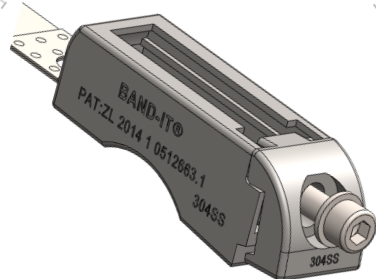

Patent: ZL 201410512663.1

- ◆ Vibration Tested
- ◆ Corrosion Resistant: Available in 304 & 316 SS
- ◆ Easy assembly & Installation: Can be installed with a hex key
- ◆ Cost Efficient: Parts can be reused and relocated after initial install

Part Number	Material		Width		Length ※1		Max Bolt Torque	Max DIA. Single Wrap		Loop Tensile Strength		Package Quantity
	Casting	Band	in	mm	in	mm	N.m	in	mm	lbs	kg	
D60059	304ss	316ss	1.1	28.1	35.4	900	25	7.9	200	4720	2141	1 EA
D60109			1.1	28.1	70.9	1800	25	19.7	500	4720	2141	1 EA
D60209			1.1	28.1	82.7	2100	25	23.6	600	4720	2141	1 EA
D60309			1.1	28.1	94.5	2400	25	27.6	700	4720	2141	1 EA
D60409			1.1	28.1	106.3	2700	25	31.5	800	4720	2141	1 EA

※1 We can add different length for band if necessary.

### Heavy Duty Bolt Clamp installation process

